



**BB&S**  
LIGHTING PEOPLE

# PIPELINE REFLECT™

## PIPELINE REFLECT SPECIFICATIONS

### BB&S Pipeline Reflect System

Due to the popularity of our color-accurate (3200°K, 4300°K, or 5600°K) remote phosphor LED Pipeline lighting, the BB&S engineering team has devised a new system based on the 1" cylindrical linear Pipes. Pipeline Reflect incorporates a new range of superior quality reflectors offering optimal control, and light dispersion spanning a 90° angle with practically no spill. Plus, the new Reflect System offers double the foot-candle output of the Pipes alone. And like all BB&S fixtures, the versatile Pipeline Reflect features offer strobe capability, especially when used with the optional BB&S 4-Way Controller. Pipeline reflect comes in single pipes as well as banks.

### Perfect Color Rendering 1' to 8' long

The Reflect System utilizes the same 97TLCI color-accurate rendering remote phosphor 1"/25mm diameter LED Pipes that Pipeline is known for. Available standard in lengths from 1' to 8', Reflect housings are made of rigid, extruded aluminum with a contoured base, 1.5" high sidewalls and a 2" wide opening. Smart engineering compresses the angle of illumination to double the Lux count over distance, compared to Pipes used alone.

### Studio Hero

Reflect single fixtures, are available in 1', 2', 3', 4', 6', and 8' lengths. It is ideal for studio grids, or anchor desks for a clean up light on talent and the perfect solution for today's demanding full or semi automated Walk Around Studios. Set designers will appreciate that the housings are black so your installation will look nice and clean.

### POWER

- 10W / Foot

### CONTROL

- DMX 512/ RDM
- 8/16 bit dimming from 0 to 100 %
- Manual operation with Pipeline Free dimmer for use with ac supply or D-tap from V-lock or goldmount.
- Dmx control with BB&S 4Way Controller

### Temperture Range:

Ambient operation from -20° to 40°C / -4° to 104° F

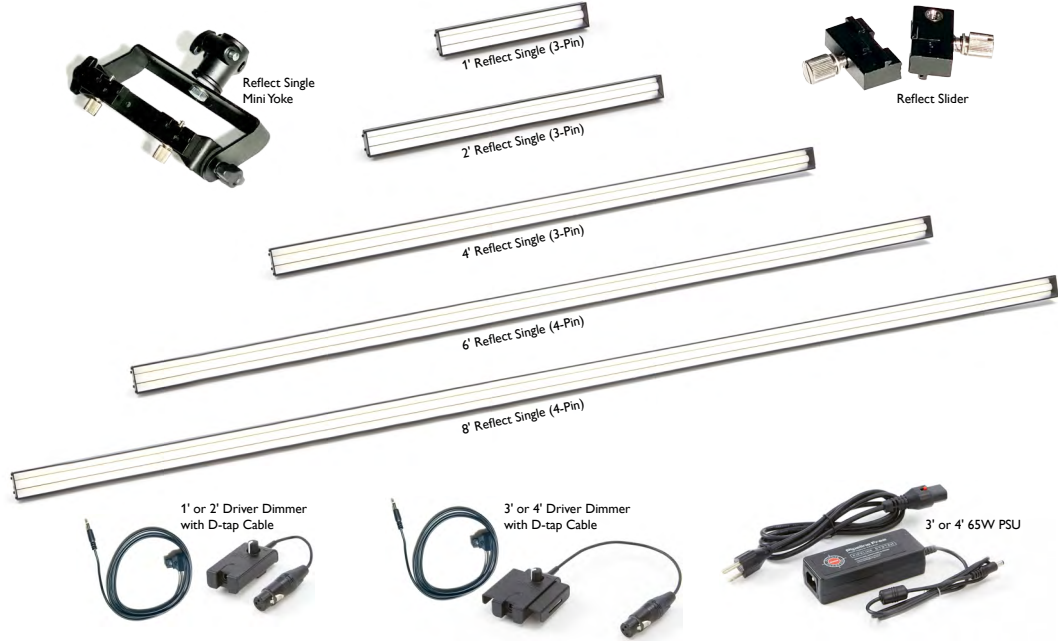

**BB&S**  
LIGHTING PEOPLE  
bbslighting.com



**BB&S**  
LIGHTING PEOPLE

# PIPELINE REFLECT™

## Pipeline Reflect 2 Banks

BB&S' new Pipeline Reflect 2' 2-Bank remote phosphor LED lights are so compact and lightweight with such powerful and controllable output that they are being grabbed up for use by broadcast studios, remote production, and cine work alike.

## Small broadcast studio space saver

When studio space is small, with low ceilings that often don't come with a large power drop, there's a lighting challenge. They require small form-factor lights that provide high light output, low power draw, with high TLCI 97 accurate color quality.

BB&S rides to the rescue with the Pipeline Reflect 2 Bank fixtures. They are available in 2', 4', 6', and 8' lengths and come in 3200°K, 4300°K and 5600°K versions. The 2' and 4' 2 Banks come with a yoke, and the 6' and 8' come with a center mount and can be chained together.

## Easy Mounting

Another benefit is the Reflect housing's easy mounting capability. A built-in T-Track solution allows for mounting onto grids or they can stack onto each other side-by-side.

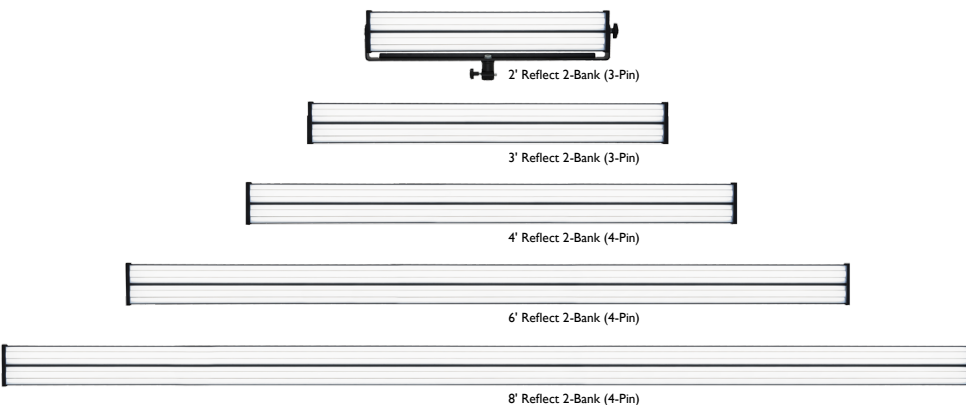

2-Bank Reflect End Cap



**BB&S**  
LIGHTING PEOPLE  
bbslighting.com



# PIPELINE REFLECT™

## PIPELINE REFLECT FEATURES

### Variety of Control Options

Made for customization, Reflect units feature a 3-pin XLR plug to allow the user to control the electronic configuration. For plug and play, fixtures may be operated via the BB&S 4-way Controller (has four 40W channels), with optional wireless DMX/RDM control or built-in DMX 512/RDM in/out (all function). All Pipes run off 48V for precise dimming.

Pipeline 10W, 20W, 30W and 40W manually controlled Driver Dimmers are available with 3-pin XLR to plug into Reflect fixtures so they can be powered by optional 20W or 65W power supplies or used with 14.4VDC D-Tap, V-Lock or goldmount batteries.

### Better Color over time

Where traditional LED fixtures may offer a partial solution for the studio, they are limited in providing highly accurate color rendering. And while their phosphor layer is applied directly onto the heat generating LEDs (that degrade over time), BB&S uses remote phosphor technology, which separates the LEDs from the color generating phosphor coating, enabling more vivid color generation, TLCI as high as 97, and less color degradation over the long term.

### From Small over Big Broadcast Studios to Run and Gun

With its small footprint, low power draw, high light output at 97 TLCI or better, and full dimming, the BB&S 2' 2-Bank remote phosphor lighting instruments are made to order for small studios and remote broadcast and ENG.

### Clean and Easy Mounting

Controllers can be wall or ceiling mounted. The 3-Pin XLR mounted within the fixture results in a cleaner installation. The Pipeline Reflect Single Pipes come with sliders.

### Upcoming Accessories

Barn doors, gel set, grid accessories, and optional removable gel filters will be available soon.

- Twice the Lux count over distance as Pipes without Reflect Housing
- Variety of Lengths: 1', 2', 3', 4', 6', 8'
- Perfect Rendering 97 TLCI Remote Phosphor Pipes
- Choice of 3200°K, 4300°K or 5600°K
- 90-degree angle dispersion
- Minimized Spill
- Robust aluminum housing
- Easy Mount
- Optional battery operation
- Compatible with BB&S 4-way Controller with DMX/RDM 512 in/out (all function)
- Strobe capability, especially when used with optional BB&S 4-Way Controller
- 48V for precise dimming

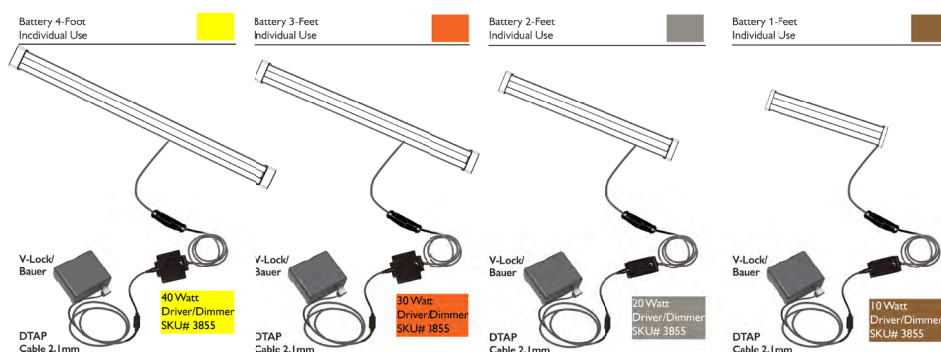
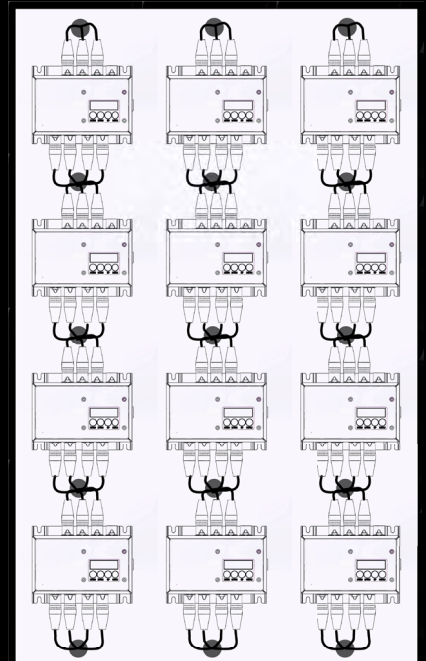



# PIPELINE REFLECT™

## Photometrics

### Single 1' Reflect

Single 1' 3200°K						Single 1' 5600°K					
Distance Feet	3	17	23	33	66	Distance Feet	3	17	23	33	66
Footcandles	37	9	4	2	1	Footcandles	46	11	5	3	2
Distance Meters	1	5	7	10	20	Distance Meters	1	5	7	10	20
LUX	402	101	45	25	16	LUX	492	123	55	31	20

### Single 2' Reflect

Single 2' 3200°K						Single 2' 5600°K					
Distance Feet	3	17	23	33	66	Distance Feet	3	17	23	33	66
Footcandles	74	18	8	5	3	Footcandles	90	22	10	6	4
Distance Meters	1	5	7	10	20	Distance Meters	1	5	7	10	20
LUX	794	199	88	50	32	LUX	966	242	107	60	39

### Single 3' Reflect

Single 3' 3200°K						Single 3' 5600°K					
Distance Feet	3	17	23	33	66	Distance Feet	3	17	23	33	66
Footcandles	103	26	11	6	4	Footcandles	127	32	14	8	5
Distance Meters	1	5	7	10	20	Distance Meters	1	5	7	10	20
LUX	1111	278	123	69	44	LUX	1368	342	152	86	55

### Single 4' Reflect

Single 4' 3200°K						Single 4' 5600°K					
Distance Feet	3	17	23	33	66	Distance Feet	3	17	23	33	66
Footcandles	160	40	18	10	6	Footcandles	176	44	20	11	7
Distance Meters	1	5	7	10	20	Distance Meters	1	5	7	10	20
LUX	1719	430	191	107	69	LUX	1891	473	210	118	76

### Single 6' Reflect

Single 6' 3200°K						Single 6' 5600°K					
Distance Feet	3	17	23	33	66	Distance Feet	3	17	23	33	66
Footcandles	206	51	23	13	8	Footcandles	241	60	27	15	10
Distance Meters	1	5	7	10	20	Distance Meters	1	5	7	10	20
LUX	2213	553	246	138	89	LUX	2596	649	288	162	104

### Single 8' Reflect

Single 8' 3200°K						Single 8' 5600°K					
Distance Feet	3	17	23	33	66	Distance Feet	3	17	23	33	66
Footcandles	304	76	34	19	11	Footcandles	334	84	38	21	13
Distance Meters	1	5	7	10	20	Distance Meters	1	5	7	10	20
LUX	3266	817	363	203	131	LUX	3593	899	399	224	144

## PIPELINE REFLECT SKU NUMBERS

BBS-3807 Pipeline Reflect 1' 3200°K  
BBS-3809 Pipeline Reflect 1' 5600°K

BBS-3810 Pipeline Reflect 2' 3200°K  
BBS-3812 Pipeline Reflect 2' 5600°K

BBS-3813 Pipeline Reflect 3' 3200°K  
BBS-3815 Pipeline Reflect 3' 5600°K

BBS-3816 Pipeline Reflect 4' 3200°K  
BBS-3818 Pipeline Reflect 4' 5600°K

BBS-3819 Pipeline Reflect 6' 3200°K  
BBS-3821 Pipeline Reflect 6' 5600°K

BBS-3822 Pipeline Reflect 8' 3200°K  
BBS-3824 Pipeline Reflect 8' 5600°K



# PIPELINE REFLECT™

## Photometrics

### 2' 2-Bank Reflect

2' 2-Bank 3200°K						2' 2-Bank 5600°K					
Distance Feet	3	17	23	33	66	Distance Feet	3	17	23	33	66
Footcandles	145	36	16	9	6	Footcandles	178	45	20	11	7
Distance Meters	1	5	7	10	20	Distance Meters	1	5	7	10	20
LUX	1560	390	173	97	62	LUX	1916	479	213	120	77

### 4' 2-Bank Reflect

4' 2-Bank 3200°K						4' 2-Bank 5600°K					
Distance Feet	3	17	23	33	66	Distance Feet	3	17	23	33	66
Footcandles	290	72	32	18	12	Footcandles	356	90	40	22	14
Distance Meters	1	5	7	10	20	Distance Meters	1	5	7	10	20
LUX	3120	780	346	194	124	LUX	3832	958	426	240	154

### 6' 2-Bank Reflect

6' 2-Bank 3200°K						6' 2-Bank 5600°K					
Distance Feet	3	17	23	33	66	Distance Feet	3	17	23	33	66
Footcandles	406	100	45	26	16	Footcandles	470	117	53	29	20
Distance Meters	1	5	7	10	20	Distance Meters	1	5	7	10	20
LUX	4360	1089	485	272	175	LUX	5062	1266	562	316	203

### 8' 2-Bank Reflect

8' 2-Bank 3200°K						8' 2-Bank 5600°K					
Distance Feet	3	17	23	33	66	Distance Feet	3	17	23	33	66
Footcandles	602	150	68	38	23	Footcandles	665	166	75	42	25
Distance Meters	1	5	7	10	20	Distance Meters	1	5	7	10	20
LUX	6467	1618	719	403	260	LUX	7149	1788	794	445	287

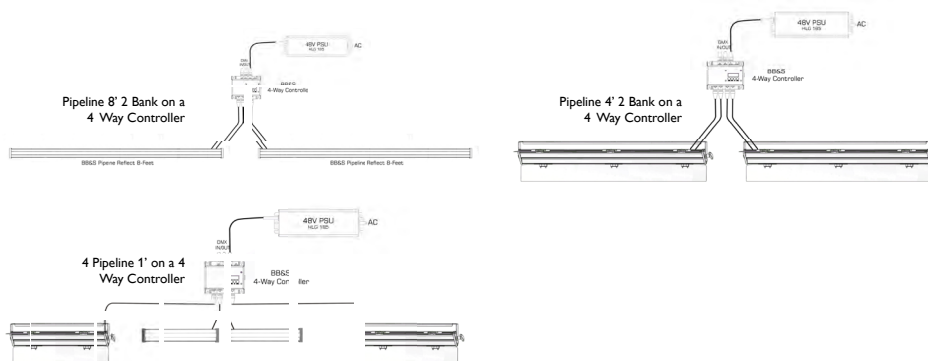

## PIPELINE REFLECT SKU NUMBERS

BBS-3825 2' 2-Bank 3200°K  
BBS-3827 2' 2-Bank 5600°K

BBS-3831 4' 2-Bank 3200°K  
BBS-3833 4' 2-Bank 5600°K

BBS-3834 6' 2-Bank 3200°K  
BBS-3836 6' 2-Bank 5600°K

BBS-3837 8' 2-Bank 3200°K  
BBS-3839 8' 2-Bank 5600°K

**BB&S SALES INTERNATIONAL**  
sales@brothers-sons.dk  
Tel +45 70 27 42 41

**BB&S SALES U.S.A.**  
info@bbslighting.com  
Tel 1-800-820-6610

**BB&S RENTAL & SALES SUPPORT**  
info@bbsrentalsupport.com  
Tel +46 70 333 78 00

